

BOCLOCK

SMART AND SAFE CONNECTOR
FOR YOUR PROCESS INSTALLATIONS

Life Solutions

BocLock is a connection system for securing process connections both from a mechanical point of view and from an automation point of view. This system is intended for any hygienic application requiring frequent connections and disconnections. It can be used on rigid saddles or hoses with the same level of security. Thanks to RFID technology, a multicolored indicator continuously indicates to the operator the state of the connection (not used, awaiting connection, closed and sealed, dirty connection, clean, incompatible, etc.) The mechanical design of the connector also presents many advantages.

IMPROVED ERGONOMICS

- ✓ Quick and ergonomic operation, requiring no tools and minimal effort, and without risk of the joint falling
- ✓ Ease of use for the operator: one handed operation for fitting and closing the connector
- ✓ Reduction of MSDs (musculoskeletal disorders)
- ✓ Time-saving: significantly reduced handling time (15 seconds to cycle the BocLock versus 2 minutes on average for a conventional connector)

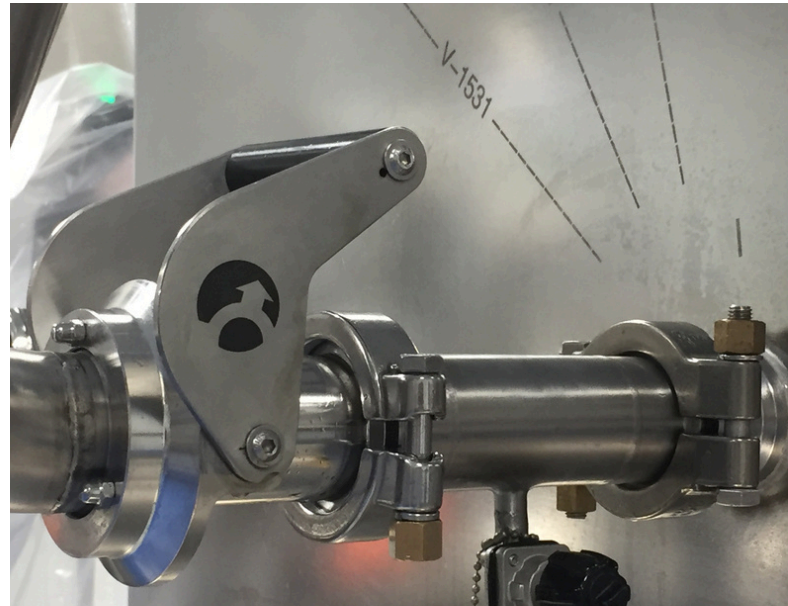

REINFORCED HYGIENE

- ✓ BocLock tightness ensured by a standard aseptic tri-clamp joint
- ✓ BocLock can be integrated into an existing system thanks to its hygienic adapters
- ✓ Stainless steel construction: autoclavable assembly

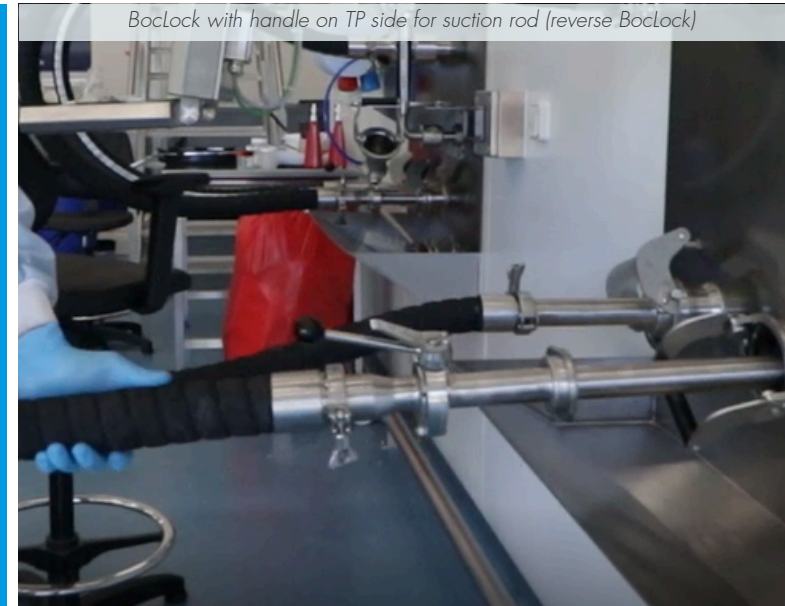

BocLock with handle on TP side for suction rod (reverse BocLock)

CHARACTERISTICS

- ✓ Tri-clamp joint with FDA and USP VI certificates
- ✓ Traceability: lot number marking or series
- ✓ Parts in contact with the product (standard): 316L stainless steel 1,4404, $Ra \leq 0.4\mu m$ (EP optional), with material certificate according to 3.1
- ✓ Other stainless steel grades available (AL-6XN; 316Ti; 904L)
- ✓ Handle: food-grade plastic with (or without) integrated RFID chip, stainless steel handle also available
- ✓ Dimensional standards: SMS (ISO2037), ISO (ISO1127), OD (BS4825), DIN (DIN11850), ASME BPE

BocLock - Female Part (ref. BLPF)
Dimensions (mm)

DN	A	B	C	D	E
20-40	354	115	435	107	156
50	354	115	503	107	156
65	354	115	57	1,205	156
80	354	150	69	148	201
100	354	150	78	162	201

BocLock - Male Part (ref. BLPM)
Dimensions (mm)

DN	A	C	D
20-40	30	32	51
50	30	39	64
65	30	46	78
80	30	53	92
100	30	67	120

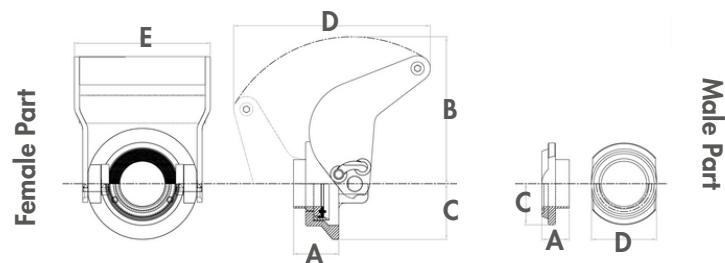

Transfer panel for raw material introduction and sample taking with cleaning in place of hoses and rods

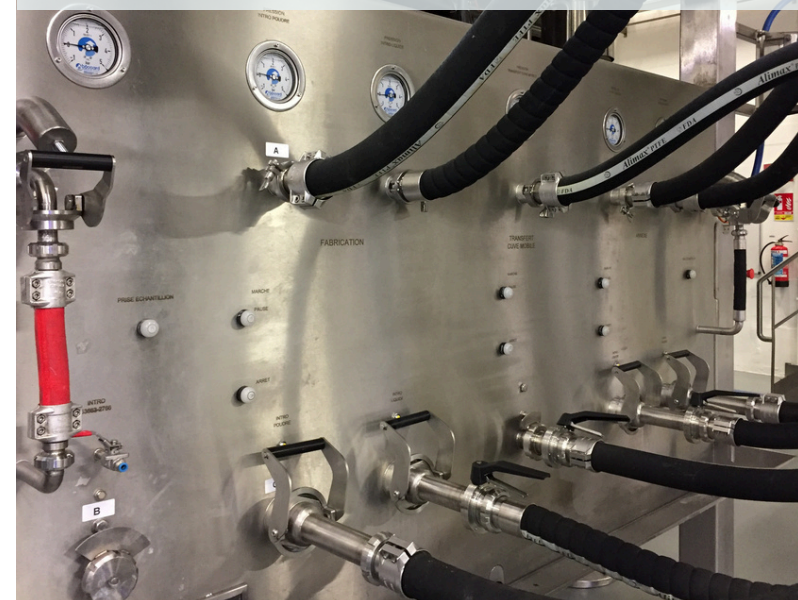

MECHANICAL SAFETY

- ✓ Risk of projection towards the operator eliminated
- ✓ Guarantee of correct alignment of the clamp joint
- ✓ Increase in the service life of the joint, due to the reproducibility of the joint tightening: the joint is always compressed with the same pressure
- ✓ The tightening torque of the joint becomes a qualifiable value

PROCESS SAFETY

- ✓ Secured process thanks to RFID chips: elimination of the risk of error, especially in sensitive environment
- ✓ Visual guidance for operators thanks to the RFID detection indicators
- ✓ Management in supervision of the sanitary condition of flexible and mobile circuits: clean, dirty, sterile, compatible or not
- ✓ ATEX certified

Transfer panel converted to BocLock version (use of clamp/BocLock adapters) to keep the original TP



TECHNOLOGIES & SERVICES



OPERATE & MAINTAIN

- Installation and Commissioning
- Spare Parts
- On-site Troubleshooting
- Remote Troubleshooting
- Predictive Maintenance



UPGRADE & EXTEND

- Process Upgrades
- Automation Upgrades
- Plant Extensions
- Production Lines Extensions
- Modernizations



OPTIMIZE & BOOST

- Performance Audits
- Remote Monitoring
- Performance Tools
- Equipment Tests
- Training Services

BOCCARD LIFE SOLUTIONS



CONTACT US

Boccard Life Solutions
Technologies & Services

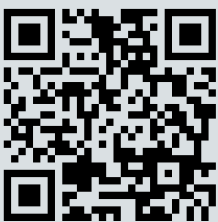

food-ts@boccard.com
cosmetics-ts@boccard.com
pharma-ts@boccard.com

www.boccard.com

We design, manufacture, assemble and install turnkey processing solutions for our customers worldwide who transform raw materials into products for people's direct consumption.

That is why our centers of excellence (Food & Ingredients, Cosmetics & Hygiene, Pharma & Biotech and Brewery) are committed to achieving the highest levels of quality and safety in over 100 countries, while ensuring optimal productivity to serve demanding markets.

Our experts in Process Intelligence and Project Management work on a partnership basis with companies of all sizes, including major global players, to build new facilities or upgrade existing systems to meet and surpass key performance indicators: product excellence and consistency, efficient time-to-market, responsiveness and flexibility.

In everything we do, our goal is to provide you with the best process experience, now and in the future.